

AR-40-4D



All time favourite model which becomes industry standard.

### STANDARD FEATURES

Insulation	Polyurethane foam injected under 500 tons of pressure to ensure uniformity and high structural strength.
Finish	Tough, hygienic construction, exterior bodies are of 304 grade stainless steel no.4 finish. Door frame and mullion are of 430 grade stainless steel for magnetic gaskets. Interior is 304 stainless steel 2B finish. Zincalume steel top, base and back.
Door	Choices of full door or half door stainless steel or full door or half door double pane 3 mm. heat reflective insulated glass. Self closing door with easily replaceable magnetic gasket. Mullion heater standard for freezer units but option for refrigerator.
Refrigerator system	Self-contained, easily removable, top mounted condensing unit. Fitted with condensate evaporator, no drain connection required.
Controller	Multi-function microprocessor controlled with digital thermometer display.
Refrigerant	• R404a for freezer • R134a for chiller
Shelves / GN pan	Complete with 3 pcs. PVC coated wire shelves per full door. Stainless steel angle slide, suit GN 2/1 pan size.
Other features	Coved stainless steel floor pan. Interior light. Heavy duty, adjustable, stainless steel bullet feet. Left hinge or right hinge selectable.
Optional extra	<ul style="list-style-type: none"> <li>Stainless steel wire shelves.</li> <li>Remote condensing unit.</li> <li>Stainless steel base and back.</li> <li>Locking plate or Cylindrical locks.</li> <li>Mullion heater for refrigerator.</li> <li>Swivel castors.</li> <li>Double pane heat reflective glass door.</li> </ul>

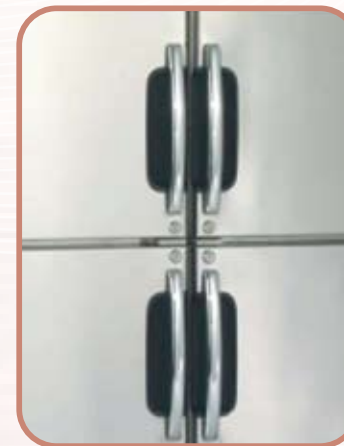

Detail : 1



Detail : 2

Dimension :

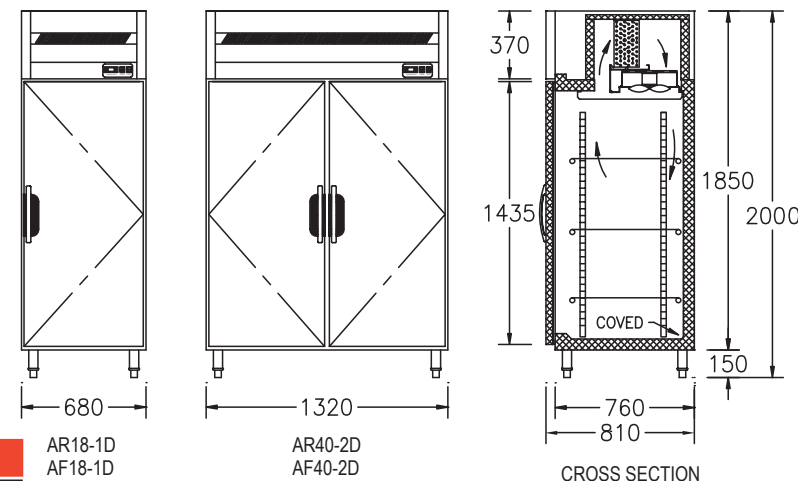

### TECHNICAL DATA

#### Refrigerated Models

#### Freezer Models

	AR-18	AR-40	AR-60	AF-18	AF-40	AF-60
Model number	AR-18	AR-40	AR-60	AF-18	AF-40	AF-60
Dimension L x D x H (mm.)	680 x 810 x 2000	1320 x 810 x 2000	1975 x 810 x 2000	680 x 810 x 2000	1320 x 810 x 2000	1975 x 810 x 2000
Capacity Cu. Ft./ Litres	18/530	40/1151	60/1695	18/530	40/1151	60/1695
Temperature range	2°C to 5°C			-18°C to -20°C		
Cooling capacity (Btu.)	1280	2528	3634	21628	3067	4343
Compressor	1/6	1/3	1/2	3/4	1	2
Shelves	3	6	9	3	6	9
Mullion heater (full/half doors)	Optional			62/82 w.	124/164 w.	186/246 w.
Defrosting system	Circulated air			Electric		
Power supply	220-240 V / 1 Ph. (50 Hz models are available.)					

Dealer :

